



VESTIL MANUFACTURING CORP.

2999 North Wayne Street, P.O. Box 507, Angola, IN 46703

Telephone: (260) 665-7586 -or- Toll Free (800) 348-0868

Fax: (260) 665-1339

www.vestilmfg.com e-mail: sales@vestil.com

**HORIZ-70 HORIZONTAL DRUM CARRIER
INSTRUCTION MANUAL**

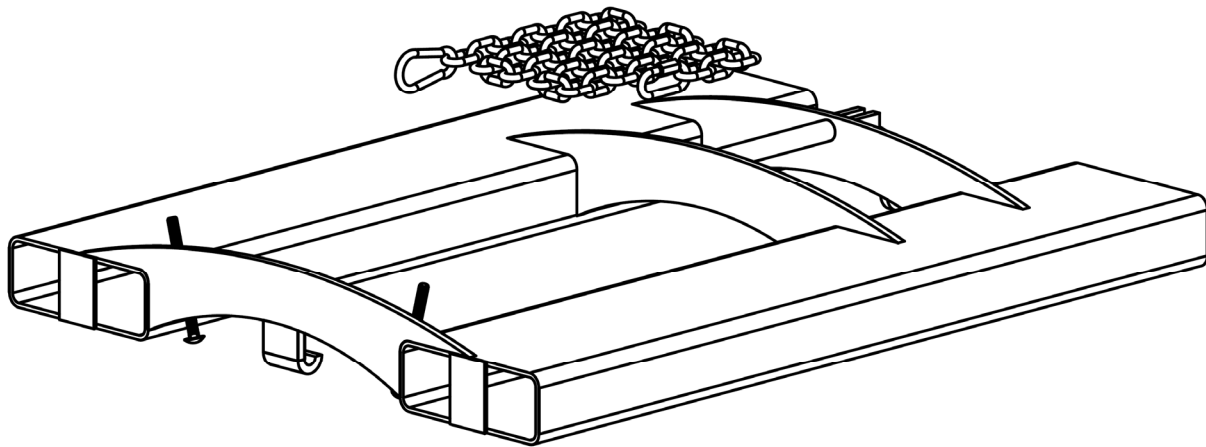

Receiving instructions:

After delivery, remove the packaging from the product. Inspect the product closely to determine whether it sustained damage during transport. **If damage is found, immediately record a complete description of it on the bill of lading.** If the product is undamaged, discard the packaging.

Notes:

- 1) Compliance with laws, regulations, codes, and non-voluntary standards enforced in the location where the product is used is exclusively the responsibility of the owner/end-user.
- 2) VESTIL is **not liable** for any injury or property damage that occurs as a consequence of failing to apply either:
 - a) Instructions in this manual; or b) information provided on product labels.

Table of Contents

| | |
|--------------------------------|-------|
| Signal words..... | 2 |
| Safe use recommendations..... | 2 |
| Specifications..... | 3 |
| Use instructions..... | 4 |
| Inspections & Maintenance..... | 4 - 5 |
| Labeling diagram | 5 |
| Limited warranty..... | 6 |

Signal words:

This manual uses SIGNAL WORDS to indicate the likelihood of personal injuries, as well as the probable seriousness of those injuries, if the product is misused in the ways described. Other signal words call attention to uses of the product likely cause property damage. The signal words used appear below along with the meaning of each word:



Identifies a hazardous situation which, if not avoided, **WILL** result in **DEATH** or **SERIOUS INJURY**. Use of this signal word is limited to the most extreme situations.



Identifies a hazardous situation which, if not avoided, **COULD** result in **DEATH** or **SERIOUS INJURY**.



Indicates a hazardous situation which, if not avoided, **COULD** result in **MINOR** or **MODERATE** injury.



Identifies practices likely to result in product/property damage, such as operation that might damage the product.

Hazards of Improper Use:

VESTIL strives to identify foreseeable hazards associated with the use of its products. However, material handling is inherently dangerous and no manual can address every conceivable risk. The end-user ultimately is responsible for exercising sound judgment at all times.



If this product is used improperly or carelessly, the operator and/or bystanders might sustain serious personal injuries or even be killed. To reduce the likelihood of injury:

• ***Failure to read and understand the entire manual before installing, using or servicing the product for the first time is a misuse of the product. If you do not understand an instruction, ask your supervisor for clarification before using the carrier.***

- Read the manual to refresh your understanding of proper use and maintenance procedures.
- DO NOT attempt to resolve any problem(s) with the product unless you are both authorized to do so and *certain* that it will be safe to use afterwards.
- DO NOT modify the product in any way UNLESS you first obtain written approval from VESTIL. Unauthorized modifications automatically void the Limited Warranty and might make the product unsafe to use.
- Inspect the product before each use.
 - A. DO NOT use this product if the inspection reveals structural damage. Examples of structural damage include, but are not limited to, the following: 1) Cracked, broken or significantly deformed load-bearing members; 2) cracked welds; 3) missing or deformed safety chain/strap; 3) corrosion, severe wear, or other condition that affects the ability of the product to support weight or itself. Replace each part that fails to pass an inspection, and DO NOT use the product until it is *fully* restored to normal condition.
 - B. DO NOT use the product if any unusual noise or movement is observed. If a malfunction occurs, remove the unit from service and notify your supervisor & maintenance personnel about the issue.
- ONLY raise the forks as high as necessary to put the trailer in a horizontal (level) position for towing. If using the hoist hook attachment, only raise the forks as high as necessary to raise the load off of the ground and to avoid contact with obstacles in the travel path.
- DO NOT use the carrier to transport *anything* but appropriately sized drums.
- ONLY use this carrier consistent with the fork truck training you received.
- DO NOT stand, or allow other persons to stand, beneath any part of the carrier or drum.
- ONLY transport drums in accordance with the fork truck training you received.
- DO NOT use the lifter to transport a drum over rough, uneven, or damaged terrain UNLESS the drum is secured to the carrier with a ratchet strap.
- DO NOT modify the drum carrier or any component of the lifter in any way UNLESS you first obtain written approval from Vestil. Unauthorized modifications automatically void the Limited Warranty (p. 6) and might make the device unsafe to use.
- DO NOT use the carrier UNLESS all product labels (see "Label placement diagram" on p. 5) are readable and undamaged.

Specifications:

Dimensions and other product information appear in the following diagrams and table.

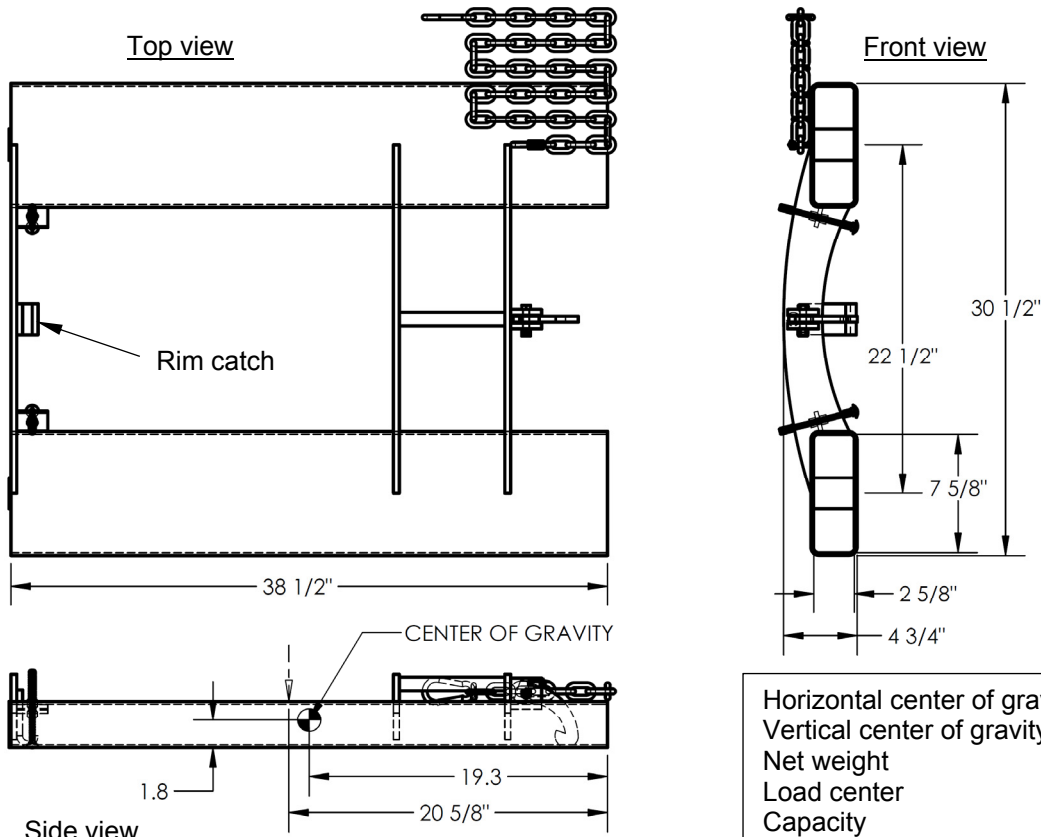

Exploded parts diagram and bill of materials

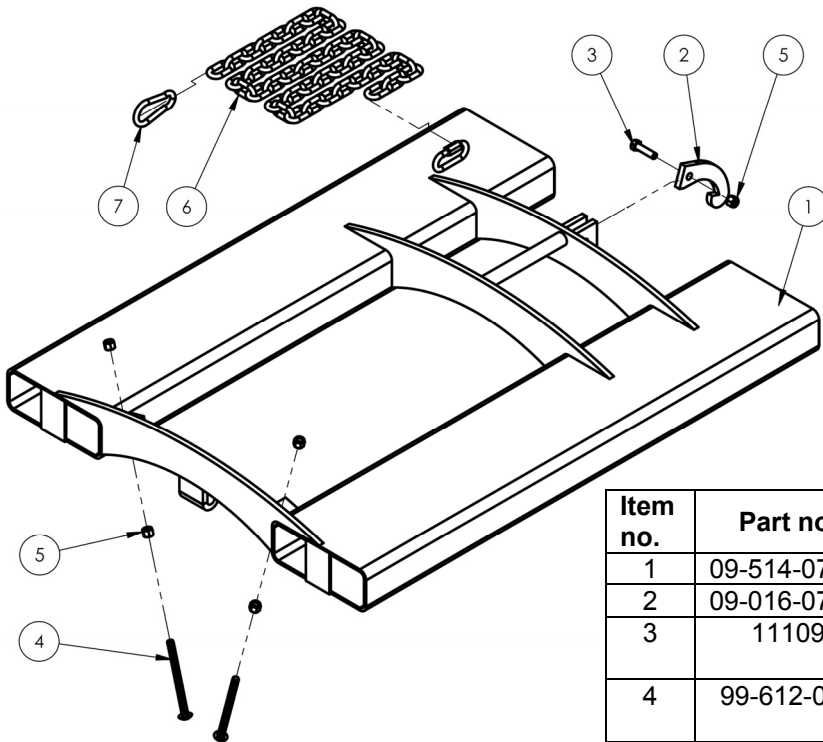

| Item no. | Part no. | Description | Qty. |
|----------|------------|--|------|
| 1 | 09-514-070 | Weldment, frame | 1 |
| 2 | 09-016-074 | Bracket, hook | 1 |
| 3 | 11109 | Hex bolt, grade A, zinc finish, 3/8" - 16 x 1 1/2" | 1 |
| 4 | 99-612-001 | Carriage bolt & nut combo., 3/8" - 16 x 5" | 2 |
| 5 | 37024 | Nylon insert lock nut, grade 2, zinc finish, 3/8" - 16 | 5 |
| 6 | 09-145-018 | 5/16" chain 56" long | 1 |
| 7 | 08-145-041 | Specialty hardware, snap hook, 5/16" | 1 |

Use Instructions:

Step 1: Adjust the positions of the forks/tines of your lift truck to match the locations of the fork pockets. Apply the operation procedures learned during your lift truck training program to properly adjust fork position.

Step 2: Mount the drum carrier on the forks of your lift truck. Slowly drive the truck forward until the forks contact the ends of the fork pockets.

Step 3: Connect the carrier to the fork truck by attaching the safety chain to the fork carriage. Wrap the chain around the fork carriage; then fasten the snap hook to the chain **without slack**. The chain must not be able to disconnect from the carriage without deliberate effort and the drum carrier should not be able to slide on the forks.

⚠ WARNING The chain is an essential safety-enhancing feature. Use the chain to connect the drum carrier to the *carriage* of your fork truck **with no slack**. *The chain will not prevent the drum carrier from sliding off of the forks if it is improperly connected to the fork carriage.*

NOTE: To see a video demonstrating how to engage a drum with the carrier as described in steps 4-9 below, visit http://vestilmfg.com/products/dhequip/horizontal_drum_cradle.htm.

Step 4: Lay the drum on its side and raise the forks above the drum. Tilt the mast of the fork truck backwards (towards the cab) and approach the bottom of the drum.

Step 5: Drive slowly towards the selected drum until the hook bracket (item no. 2 in Fig. 1, p. 3) engages the rim of the drum.

Step 6: Continue to slowly drive forward while leveling the forks (i.e. tilting the mast away from the cab of the fork lift). Drive forward until the rim catch at the front end of the carrier extends beyond the opposite end of the drum.

Step 7: Tilt the forks forward until the rim catch is below the rim of the drum; then slowly drive in reverse until the rim slides under the rim.

Step 8: Slowly raise the forks until the drum is elevated a few inches. Transport the drum to the desired unloading location.

Step 9: Release the drum by lowering the forks until the drum rests on the ground. Lower the forks enough to allow the rim catch and rim to disengage. Slowly drive forward until the rim catch is free of the drum; then tilt the mast backwards to raise the tips of the forks. Slowly back the fork truck away from the drum until the hook bracket disengages the opposite rim.

Maintenance:

NOTICE Proper use, maintenance, and storage are essential for this product to function properly.

- Always use this product in accordance with the instructions in this manual and consistent with any training relevant to machines, devices, etc. used in conjunction with this product.
- Keep the product clean & dry. Periodically lubricate moving parts.

Before each use, inspect the listed components:

1. Safety chain and snap hook: confirm that the spring latch (of the snap hook) automatically closes securely. **DO NOT** use the carrier if the hook, chain, or cold shut (the loop welded to the frame, which connects to one end of the chain) is damaged.
2. Product labels: all labels should be readable and located as shown in the label placement diagram on p. 5. If a label(s) is unreadable or missing, contact Vestil to order a replacement.

At least 1 time per month, inspect:

1. Fasteners (hardware):
 - Bolts, nuts, washers, pins, cotter pins;
 - Chain and snap hook.

2. Fork pockets: confirm that each pocket is structurally sound. Do not use the carrier if either fork pocket is structurally compromised.
3. Welds: confirm that all welds are intact.
4. Hook bracket, rim catch, and supporting frame: must be undamaged, for example, no structural deformation, warps, or cracks, rust or corrosion. The structure should be clean, square and rigid, and free of rust and corrosion. Remove dirt and debris. Do not use the lifter if the supporting frame and/or one or both grippers are excessively rusted or corroded.

Labeling diagram:

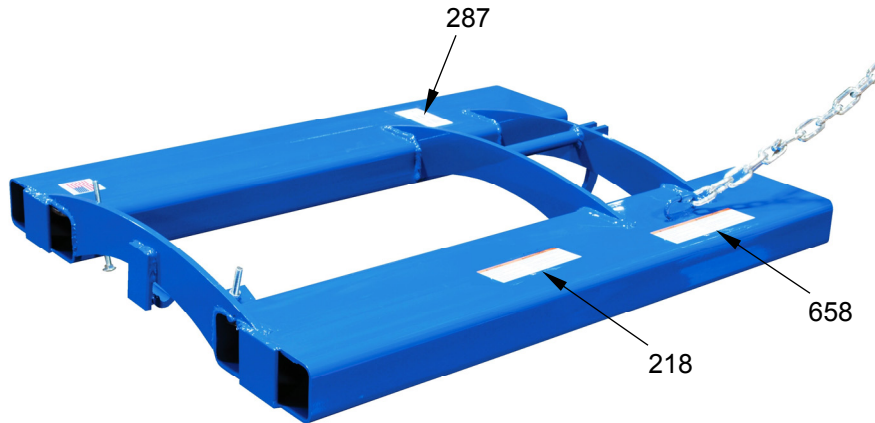

Label 287

| | |
|---------------------|------------|
| MODEL/MODÉLO/MOÐÈLE | _____ |
| CAPACITY | _____ lbs. |
| CAPACIDAD/CAPACITÉ | _____ kgs. |
| SERIAL/SERIE/SÉRIE | _____ |

Label 658

| ⚠ WARNING | ⚠ ADVERTENCIA | ⚠ AVERTISSEMENT |
|---|--|---|
| Do not operate or move with unstable loads DO NOT LOAD beyond rated capacity DISTRIBUTE LOAD EVENLY DO NOT sit or ride | No use a mueva con cargas inestables No cargue mas de la capacidad tasada DISTRIBUYA LA CARGA A NIVEL NO SE SIENTE o vaya en el carro | Ne pas utiliser avec une charge instable NE PAS CHARGER au-delà du débit nominale DISTRIBUER la charge régulièrement NE PAS VOUS ASSEoir OU VOUS PROMENER sur le chariot |

658
rev 0808

Label 218

| ⚠ WARNING | ⚠ ADVERTENCIAS |
|--|---|
| Improper use might result in death or serious personal injury. Attach device to fork carriage with safety chain/strap. <ul style="list-style-type: none"> • Drive lift truck forward until forks contact ends of fork pockets • Chain/straps must not be able to disconnect (slide free) from carriage. • Safety chain/strap must be taut. Connect chain/strap to carriage via shortest line. | El uso impropio puede resultar en muerte o heridas personales. Atar aparato al mástil del montacargas con cadenas/correas. <ul style="list-style-type: none"> • Maneje el montacargas para adelante hasta que las cuñas hagan contacto con la orilla del bolsillo de las cuñas. • La cadenas y correas no deben de deslizarse (soltarse) del mástil del montacargas. • La cadena/correa de seguridad debe de estar apretado. Asegure la cadena/correa al mástil via la ruta mas corta. |

218
rev/0910

LIMITED WARRANTY

Beacon Industries, Inc. ("Beacon") warrants this product to be free of defects in material and workmanship during the warranty period. *Our warranty obligation is to provide a replacement for a defective original part if the part is covered by the warranty, after we receive a proper request from the warrantee (you) for warranty service.*

Who may request service?

Only a warrantee may request service. *You are a warrantee if* you purchased the product from Beacon or from an authorized distributor AND Beacon has been fully paid.

What is an "original part"?

An original part is a part used to make the product as shipped to the warrantee.

What is a "proper request"?

A request for warranty service is proper if Beacon receives: 1) a photocopy of the Customer Invoice that displays the shipping date; AND 2) a written request for warranty service including your name and phone number. Send requests by any of the following methods:

| | |
|------------------------|----------------|
| <u>Mail</u> | <u>Fax</u> |
| Beacon Industries, Inc | (314) 487-0100 |
| 12300 Old Tesson Rd. | <u>Phone</u> |
| St. Louis, MO 63128 | (314) 487-7600 |

In the written request, list the parts believed to be defective and include the address where replacements should be delivered.

What is covered under the warranty?

After Beacon receives your request for warranty service, an authorized representative will contact you to determine whether your claim is covered by the warranty. Before providing warranty service, Beacon may require you to send the entire product, or just the defective part or parts, to its facility in Angola, IN. The warranty covers defects in the following *original* dynamic components: motors, hydraulic pumps, electronic controllers, switches and cylinders. It also covers defects in *original* parts that wear under normal usage conditions ("wearing parts"): bearings, hoses, wheels, seals, brushes, batteries, and the battery charger.

How long is the warranty period?

The warranty period for original components is 1 YEAR. The warranty period begins on the date when Beacon ships the product to the warrantee. If the product was purchased from an authorized distributor, the period begins when the distributor ships the product. Beacon may extend the warranty period for products shipped from authorized distributors by *up to* 30 days to account for shipping time.

If a defective part is covered by the warranty, what will Beacon do to correct the problem?

Beacon will provide an appropriate replacement for any *covered* part. An authorized representative of Beacon will contact you to discuss your claim.

What is not covered by the warranty?

1. Labor;
2. Freight;
3. Occurrence of any of the following, which automatically voids the warranty:
 - Product misuse;
 - Negligent operation or repair;
 - Corrosion or use in corrosive environments;
 - Inadequate or improper maintenance;
 - Damage sustained during shipping;
 - Collisions or other incidental contacts causing damage to the product;
 - Unauthorized modifications: DO NOT modify the product IN ANY WAY without first receiving written authorization from Beacon. Modification(s) might make the product unsafe to use or might cause excessive and/or abnormal wear.

Do any other warranties apply to the product?

Beacon Manufacturing Corp. makes no other express warranties. All implied warranties are disclaimed to the extent allowed by law. Any implied warranty not disclaimed is limited in scope to the terms of this Limited Warranty.